

**BEFORE THE  
SURFACE TRANSPORTATION BOARD**

---

ENTERED  
Office of Proceedings  
September 27, 2023  
Part of  
Public Record

**STB DOCKET NO AB-768X**

---

**MOHAWK, ADIRONDACK & NORTHERN RAILROAD CORPORATION  
ABANDONMENT EXEMPTION, IN LEWIS AND JEFFERSON  
COUNTIES, N.Y.**

**STB DOCKET NO AB -180X**

**THE LOWVILLE & BEAVER RIVER RAILROAD COMPANY-  
ABANDONMENT EXEMPTION- IN LEWIS COUNTY, N.Y.**

**RESPONSE TO REQUESTS CONTAINED IN DECISION DATED  
SEPTEMBER 25, 2023 TO SUPPLEMENT THE RECORD**

**On September 25, 2023 the Board noted several issues regarding the Abandonment Exemptions filed in the above captioned matters. The Mohawk, Adirondack & Northern Railroad Corporation (hereinafter MAN) and the Lowville & Beaver River Railroad Company (hereinafter LBRR) hereby respond to the issues and requests that the record be supplemented with the facts and requests contained therein.**

- 1. Regarding the ownership of the LBRR, it should be noted that pursuant to an agreement with the Lewis County Industrial Development Authority, the fee ownership of the property of the LBRR was returned to the LBRR on July 14, 2016 and has remained the property of LBRR ever since. A copy of the Deed to LBRR is enclosed herewith.**
- 2. The 1.15-mile branch at Beaver Falls NY is included in the sale to Lewis County but was omitted in LBRR's filing. LBRR hereby requests that**

**its Notice of Exemption for Abandonment include the Beaver Falls Branch. This being the case the Branch would no longer need to connect to the interstate rail network.**

- 3. The milepost endpoint for the Lowville-Croghan line is milepost 10.57 not 10.41.**
- 4. Since the deed from Conrail to MAN indicates that the Lowville-Carthage line extends to milepost 58.1 (see enclosed Conrail deed) that should be where the line to be abandoned extends to.**

**Please let me know if you have any other questions or concerns about the filings.**

**Sincerely**

A handwritten signature in blue ink, appearing to read "John K. Fiorilla". The signature is written in a cursive style with a large initial "J".

**John K. Fiorilla**

**CC: All Parties on Service List**

CASE NO. 69851

TO WHOM IT MAY CONCERN:

I HEREBY CERTIFY THAT BY THE AUTHORITY CONFERRED BY THE BOARD OF DIRECTORS OF CONSOLIDATED RAIL CORPORATION (CONRAIL) ON MARCH 18, 1988 TO THE CHAIRMAN AND CHIEF EXECUTIVE OFFICER TO CONDUCT THE BUSINESS AND AFFAIRS OF THE CORPORATION AND TO DELEGATE SUCH AUTHORITY AS HE MAY DEEM NECESSARY, THE CHAIRMAN, PRESIDENT AND CHIEF EXECUTIVE OFFICER DID DELEGATE ON FEBRUARY 5, 1990 TO THE SENIOR VICE PRESIDENT-DEVELOPMENT, WHO ON MARCH 6, 1990 REDELEGATED TO THE ASSISTANT VICE PRESIDENT-ASSET DEVELOPMENT, AND WHO ON MARCH 12, 1990 REDELEGATED TO THE DIRECTOR-FIELD SERVICES (A/K/A DIRECTOR-REAL ESTATE FIELD SERVICES) AND DIRECTOR-MANAGEMENT SERVICES, OR ANY OF THEM, THE AUTHORITY TO EXECUTE AND DELIVER ON BEHALF OF CONRAIL ANY AND ALL DOCUMENTS NECESSARY TO COMPLETE THE SALE OF 62.95 MILES OF THE CARTHAGE CLUSTER, TOGETHER WITH THE IMPROVEMENTS LOCATED THEREON, SITUATE IN LEWIS, ST. LAWRENCE AND JEFFERSON COUNTIES, NEW YORK, CONSISTING OF 16.20 MILES OF LOWVILLE INDUSTRIAL TRACK (LINE CODE 4751) FROM APPROXIMATELY MILE POST 58.1 IN LOWVILLE (EOT), LEWIS COUNTY TO APPROXIMATELY MILE POST 74.3 IN CARTHAGE; 0.35 OF A MILE OF THE NEWTON FALLS SECONDARY (LINE CODE 4751) FROM APPROXIMATELY MILE POST 74.3 (LOWVILLE INDUSTRIAL TRACK CONNECTION) TO APPROXIMATELY MILE POST 74.65 IN CARTHAGE; AND ALSO 46.40 MILES OF NEWTON FALLS SECONDARY (LINE CODE 4752) FROM APPROXIMATELY MILE POST 29.0 IN CARTHAGE TO APPROXIMATELY MILE POST 75.4 EOT IN NEWTON FALLS, NEW YORK, FOR THE CONSIDERATION OF \$1.00 (PLUS OTHER OBLIGATIONS ASSUMED BY THE PURCHASER) TO MOHAWK, ADIRONDACK AND NORTHERN RAILROAD CORPORATION, OR THE NOMINEE THEREOF.

  
Assistant Secretary

**D. D. MCGEEHAN**

THIS INDENTURE, made the 12<sup>th</sup> day of June Nineteen  
Hundred and Ninety-one (1991),

BETWEEN **CONSOLIDATED RAIL CORPORATION**, a Corporation of  
the Commonwealth of Pennsylvania, having an office at Six  
Penn Center Plaza, Philadelphia, Pennsylvania, 19103,  
hereinafter referred to as the Grantor, and **MOHAWK,  
ADIRONDACK AND NORTHERN RAILROAD CORPORATION**, a Corporation  
of the State of New York, having a mailing address of 8364  
Lewistown Road, Batavia, New York 14020, hereinafter referred  
to as the Grantee.

WITNESSETH: That the Grantor, for and in consideration  
of the sum of ONE DOLLAR (\$1.00), the receipt whereof is  
hereby acknowledged, and other good and valuable  
consideration, paid by the Grantee, does hereby remise,  
release, and quitclaim unto the Grantee, and the successors  
and assigns of the Grantee forever, all right, title and  
interest of the Grantor of, in and to the following described  
Premises:

ALL THAT CERTAIN property of the Grantor, together with  
all improvements thereon, being those portions of Grantor's  
lines of railroad known as the Carthage Cluster, situate in  
the Counties of Lewis, Jefferson and St. Lawrence in the  
State of New York, hereinafter referred to as "Premises" and  
described in Exhibit "A" and generally depicted in Exhibit  
"B" hereof.

EXCEPTING AND RESERVING further as noted in Exhibit "A"  
hereof.

UNDER and SUBJECT, however, to (1) whatever rights the  
public may have to the use of any roads, alleys, bridges or  
streets crossing the Premises, (2) any streams, rivers,  
creeks and water ways passing under, across or through the  
Premises, and (3) any easements or agreements of record or  
otherwise affecting the land hereby conveyed, and to the  
state of facts which a personal inspection or accurate survey  
would disclose, and to any pipes, wires, poles, cables,  
culverts, drainage courses or systems and their appurtenances  
now existing and remaining in, on, under, over, across and  
through the Premises, together with the right to maintain,  
repair, renew, replace, use and remove same.

THIS INSTRUMENT is executed and delivered by Grantor,  
and is accepted by Grantee, subject to the covenants set  
forth below, which shall be deemed part of the consideration  
of this conveyance and which shall run with the land and be  
binding upon, and inure to the benefit of, the respective  
legal representatives, successors and assigns of Grantor and  
Grantee. Grantee hereby knowingly, willingly, and  
voluntarily waives the benefit of any rule, law, custom, or



statute of the State of New York now or hereafter in force with respect to the covenants set forth below.

(1) Should a claim adverse to the title hereby quitclaimed be asserted and/or proved, no recourse shall be had against the Grantor herein.

(2) Grantor shall not be liable or obligated to provide for or supply directly or indirectly, for money or otherwise, any type of utility service to Grantee, even if the Premises are supplied utility service or services from or through Grantor owned or Grantor retained utility service facilities at the time said Premises are conveyed to Grantee; and that if Grantor at its sole discretion elects to provide any utility service or services for money or otherwise to said Premises during the period during which Grantee is arranging at Grantee's own expense for provision of utility service or services direct from public utilities, Grantee shall have no continuing right to use such service or expectation that Grantor must continue to provide it. It is further understood that Grantee's use of any utilities that are supplied through Grantor's utilities or billed to Grantor by any public utility for Grantee's use shall be at the sole cost and expense of Grantee and if Grantee fails to relocate or arrange for a separation of utility services, Grantor may arrange for a separation of the utility services at Grantee's sole cost and expense.

TOGETHER with the appurtenances and all the estate and rights of the Grantor in and to said Premises, EXCEPTING and RESERVING and UNDER and SUBJECT and provided as aforesaid.

TO HAVE AND TO HOLD the Premises herein remised, released and quitclaimed unto the Grantee, the heirs or successors and assigns of the Grantee forever, EXCEPTING and RESERVING and UNDER and SUBJECT and provided as aforesaid.

THE words "Grantor" and "Grantee" used herein shall be construed as if they read "Grantors" and "Grantees", respectively, whenever the sense of this instrument so requires and whether singular or plural, such words shall be deemed to include at all times and in all cases the heirs, legal representatives or successors and assigns of the Grantor and Grantee.

IN WITNESS WHEREOF, the Grantor has caused its

Corporate seal to be hereunto affixed and these presents to be signed by its duly authorized officer, the day and year first above written.

SEALED AND DELIVERED in the presence of us:

CONSOLIDATED RAIL CORPORATION  
By:

Juliana R. Sparks

M Virginia Ebert  
M. Virginia Ebert, Director-  
Management Services

Attest:

James W. Hartman Jr

J. D. McGEEHAN  
Assistant Secretary

COMMONWEALTH OF PENNSYLVANIA )  
COUNTY OF PHILADELPHIA )

: SS

ON THE 12<sup>th</sup> day of June, Nineteen  
Hundred and Ninety-one (1991), before me personally came M.  
Virginia Ebert, to me known, who, being by me duly sworn, did  
depose and say that she resides in Montgomery County,  
Pennsylvania and has a mailing address of Room 1500, Six Penn  
Center, Philadelphia, Pennsylvania 19103; that she is the  
Director-Management Services of CONSOLIDATED RAIL  
CORPORATION, the corporation described in, and which  
executed, the foregoing instrument; that she knows the seal  
of said corporation; that the seal affixed to said instrument  
is such corporate seal; that it was so affixed by order of  
the Board of Directors of said corporation; and that she  
signed his name thereto by like order.

Francis C. Flynn  
Notary Public

THIS INSTRUMENT PREPARED BY:

Juliana R. Sparks  
Consolidated Rail Corporation  
Fifteenth Floor, Six Penn Center  
Philadelphia, Pennsylvania 19103  
Case No. 69851

NOTARIAL SEAL  
FRANCIS C. FLYNN, NOTARY PUBLIC  
PHILADELPHIA, PHILADELPHIA-COUNTY  
MY COMMISSION EXPIRES JULY 2, 1991

Member, Pennsylvania Association of Notaries

:nls

CASE NO. 69851

DEED TO

MOHAWK, ADIRONDACK AND NORTHERN RAILROAD CORPORATION

EXHIBIT A

THIS EXHIBIT A CONTAINS 6 PAGES.

CASE NO. 69851

DEED TO  
MOHAWK, ADIRONDACK AND NORTHERN RAILROAD CORPORATION

EXHIBIT "A"

Lewis County, New York

Lowville Industrial Track, Line Code 4751

ALL THAT CERTAIN property of the Grantor, being a portion of the line of railroad known as the Lowville Secondary and identified as the Lyons Falls and Lowville Secondary Trains (a.k.a. Lowville Secondary Track) and Line Code 4751 in the Recorder's Office of Lewis County, New York in Book 392 at page 139, situate in the County of Lewis and State of New York; being further described as follows:

BEGINNING at Railroad Station 306+587, at approximately Railroad Mile Post 58.1, in the Town of Lowville, as indicated on sheet 1 of 10 of aforesaid Exhibit "B"; thence extending in a general northwesterly direction passing through the Village of Lowville, re-entering the Town of Lowville, the Town of Denmark to the County Line, the County of Lewis on the southeast and the County of Jefferson on the northwest, being at approximately Railroad Mile Post 73.3, as indicated on sheet 2 of 10 of aforesaid Exhibit "B".

BEING a part or portion of the same premises which Robert W. Blanchette, Richard C. Bond and John H. McArthur, as Trustees of the Property of the Penn Central Transportation Company, Debtor, by Conveyance Document No. PC-CRC-RP-115 dated March 30, 1976 and recorded on October 3, 1978, in the Recorder's Office of Lewis County, New York, in Liber 392, at page 134&c., and granted and conveyed unto Consolidated Rail Corporation.

THIS EXHIBIT "A" CONTAINS 6 PAGES, OF WHICH THIS IS PAGE 1 OF 6.



CASE NO. 69851

DEED TO  
MOHAWK, ADIRONDACK AND NORTHERN RAILROAD CORPORATION

EXHIBIT "A"

Jefferson County, New York

Lowville Industrial Track, Line Code 4751

ALL THAT CERTAIN property of the Grantor, being a portion of the line of railroad known as the Penn Central Lowville Branch (a.k.a. Lowville Industrial Track) and identified as Line Code 475 in the Recorder's Office of Jefferson County, New York in Book 894 at page 403, situate in the County of Jefferson and State of New York; being further described as follows:

EXTENDING from the County Line, the County of Lewis on the southeast and the County of Jefferson on the northwest, being at approximately Railroad Mile Post 73.3, as indicated on sheet 2 of 10 of aforesaid Exhibit "B", in a general northerly direction passing through the Village of West Carthage and the Town of Champion to approximately Railroad Mile Post 74.3, in the Village of Carthage and the Town of Wilna, the place of ENDING, as indicated on sheet 3 of 10 of aforesaid Exhibit "B".

BEING a part or portion of the same premises which Robert W. Blanchette, Richard C. Bond and John H. McArthur, as Trustees of the Property of the Penn Central Transportation Company, Debtor, by Conveyance Document No. PC-CRC-RP-114 dated March 30, 1976 and recorded on October 3, 1978, in the Recorder's Office of Jefferson County, New York, in Liber 894, at page 395&c., and granted and conveyed unto Consolidated Rail Corporation.

THIS EXHIBIT "A" CONTAINS 6 PAGES, OF WHICH THIS IS PAGE 2 OF 6.

DEED TO  
MOHAWK, ADIRONDACK AND NORTHERN RAILROAD CORPORATION

EXHIBIT "A"

Jefferson County, New York

Newton Falls Secondary, Line Code 4751

ALL THAT CERTAIN property of the Grantor, being a portion of the line of railroad known as the Penn Central Lowville Branch (a.k.a. Newton Falls Secondary) and identified as Line Code 4751 in the Recorder's Office of Jefferson County, New York in Book 894 at page 403, situate in the County of Jefferson and State of New York; being further described as follows:

BEGINNING at approximately Railroad Mile Post 74.3; thence extending in a general northerly direction to the north side of Adelaide Street, at approximately Railroad Mile Post 74.65, the place of ENDING, all in the Village of Carthage and Town of Wilna, as indicated on sheet 3 of 10 of aforesaid Exhibit "B".

BEING a part or portion of the same premises which Robert W. Blanchette, Richard C. Bond and John H. McArthur, as Trustees of the Property of the Penn Central Transportation Company, Debtor, by Conveyance Document No. PC-CRC-RP-114 dated March 30, 1976 and recorded on October 3, 1978, in the Recorder's Office of Jefferson County, New York, in Liber 894, at page 395&c., and granted and conveyed unto Consolidated Rail Corporation.

EXCEPTING AND RESERVING, thereout and therefrom and unto the said Grantor, its agents, employees and persons doing business with Grantor all right, title and interest in and to all radio and communication equipment including poles, wires, towers and equipment necessary therefor, hereinafter referred to as Radio Facilities, located between the aforesaid Mile Posts, and the continued right to use the freight station, free of charge, and together with the right of unimpeded and immediate ingress and egress on and over the aforesaid Premises to use, maintain, repair, renew, replace and remove Grantor's radio facilities and for access to and use of said freight station.

DEED TO  
MOHAWK, ADIRONDACK AND NORTHERN RAILROAD CORPORATION

EXHIBIT "A"

Jefferson County, New York

Newton Falls Secondary, Line Code 4752

ALL THAT CERTAIN property of the Grantor, being the line of railroad known as the Newton Falls Branch (a.k.a. Newton Falls Secondary) and identified as Line Code 4752 in the Recorder's Office of Jefferson County, New York in Book 894 at page 404, situate in the County of Jefferson and State of New York; being further described as follows:

BEGINNING at the south line of Adelaide Street, at approximately Railroad Mile Post 29, in the Village of Carthage, Jefferson County, New York, as indicated on sheet 4 of 10 of aforesaid Exhibit "B"; thence extending in a general northeasterly direction passing through the Town of Wilna to the County Line, the County of Jefferson on the west and the County of Lewis on the east, being at approximately Railroad Mile Post 33.6, as indicated on sheet 5 of 10 of aforesaid Exhibit "B".

EXTENDING from the County Line, the County of Lewis on the south and the County of Jefferson on the north, through Jefferson County being at approximately Railroad Mile Post 34.9 as indicated on sheet 6 of 10 of aforesaid Exhibit "B", in a general northeasterly direction passing through the Town of Wilna to the County Line, the County of Jefferson on the west and the County of Lewis on the east, being at approximately Railroad Mile Post 37, as indicated on sheet 7 of 10 of aforesaid Exhibit "B".

ALSO EXTENDING from the County Line, the County of Lewis on the southeast and the County of Jefferson on the northwest, being at approximately Railroad Mile Post 37.5 as indicated on sheet 7 of 10 of aforesaid Exhibit "B", in a general northerly direction through Jefferson County passing through the Town of Wilna to the County Line, the County of Jefferson on the southwest and the County of Lewis on the northeast, being at approximately Railroad Mile Post 38.2, as indicated on sheet 8 of 10 of aforesaid Exhibit "B".

BEING a part or portion of the same premises which Robert W. Blanchette, Richard C. Bond and John H. McArthur, as Trustees of the Property of the Penn Central Transportation Company, Debtor, by Conveyance Document No. PC-CRC-RP-114 dated March 30, 1976 and recorded on October 3, 1978, in the Recorder's Office of Jefferson County, New York, in Liber 894, at page 395&c., and granted and conveyed unto Consolidated Rail Corporation.

DEED TO  
MOHAWK, ADIRONDACK AND NORTHERN RAILROAD CORPORATION

EXHIBIT "A"

Lewis County, New York

Newton Falls Secondary, Line Code 4752

ALL THAT CERTAIN property of the Grantor, being the line of railroad known as the Newton Falls Branch (a.k.a. Newton Falls Secondary) and identified as Line Code 4752 in the Recorder's Office of Lewis County, New York in Book No. 392 at page 140, situate in the County of Lewis and State of New York; being further described as follows:

EXTENDING from the County Line, the County of Jefferson on the west and the County of Lewis on the east, being at approximately Railroad Mile Post 33.6, as indicated on sheet 5 of 10 of aforesaid Exhibit "B", in a northeasterly direction, through the County of Lewis, passing through the Town of Groghan to the County Line, the County of Lewis on the south and the County of Jefferson on the north, being at approximately Railroad Mile Post 34.9, as indicated on sheet 6 of 10 of aforesaid Exhibit "B".

ALSO EXTENDING from the County Line, the County of Jefferson on the west and the County of Lewis on the east, being at approximately Railroad Mile Post 37, in a general northerly direction, through the County of Lewis, passing through the Town of Croghan to the County Line, the County of Lewis on the southeast and the County of Jefferson on the northwest, being at approximately Railroad Mile Post 37.5, all as indicated on sheet 7 of 10 of aforesaid Exhibit "B".

ALSO EXTENDING from the County Line, the County of Jefferson on the southwest and the County of Lewis on the northeast, being at approximately Railroad Mile Post 38.2, as indicated on sheet 8 of 10 of aforesaid Exhibit "B", in a general northeasterly direction, through the County of Lewis, passing through the Town of Diana and the Village of Harrisville to the County Line, the County of Lewis on the southwest and the County of St. Lawrence on the northeast, being at approximately Railroad Mile Post 51, as indicated on sheet 9 of 10 of aforesaid Exhibit "B".

BEING a part or portion of the same premises which Robert W. Blanchette, Richard C. Bond and John H. McArthur, as Trustees of the Property of the Penn Central Transportation Company, Debtor, by Conveyance Document No. PC-CRC-RP-115 dated March 30, 1976 and recorded on October 3, 1978, in the Recorder's Office of Lewis County, New York, in Liber 392, at page 134&c., and granted and conveyed unto Consolidated Rail Corporation.



CASE NO. 69851

DEED TO  
MOHAWK, ADIRONDACK AND NORTHERN RAILROAD CORPORATION

EXHIBIT "A"

St. Lawrence County, New York

Newton Falls Secondary, Line Code 4752

ALL THAT CERTAIN property of the Grantor, being the line of railroad known as the Newton Falls Branch (a.k.a. Newton Falls Secondary) and identified as Line Code 4752 in the Recorder's Office of St. Lawrence County, New York in Book No. 935 at page 66, situate in the County of St. Lawrence and State of New York; being further described as follows:

EXTENDING from the County Line, the County of Lewis on the southwest and the County of St. Lawrence on the northeast, being at approximately Railroad Mile Post 51 as indicated on sheet 9 of 10 of aforesaid Exhibit "B", in a general easterly direction passing through the Towns of Pitcairn and Fine to Railroad Station 398+309, at approximately Railroad Mile Post 75.4, at Newton Falls in the Town of Clifton, the place of ENDING, as indicated on sheet 10 of 10 of aforesaid Exhibit "B".

BEING a part or portion of the same premises which Robert W. Blanchette, Richard C. Bond and John H. McArthur, as Trustees of the Property of the Penn Central Transportation Company, Debtor, by Conveyance Document No. PC-CRC-RP-132 dated March 30, 1976 and recorded on October 3, 1978, in the Recorder's Office of St. Lawrence County, New York, in Liber 935, at page 60&c., and granted and conveyed unto Consolidated Rail Corporation.

THIS EXHIBIT "A" CONTAINS 6 PAGES, OF WHICH THIS IS PAGE 6 OF 6.

CASE NO. 69851

DEED TO

MOHAWK, ADIRONDACK AND NORTHERN RAILROAD CORPORATION

EXHIBIT B

MAP ADDENDUM

THIS EXHIBIT "B" CONTAINS 10 MAPS.

V.S. 102(1020)/30-38 L.C. 4751  
V.S. 97(0970)/9-32 L.C. 4752

LOWVILLE INDUSTRIAL TRACK

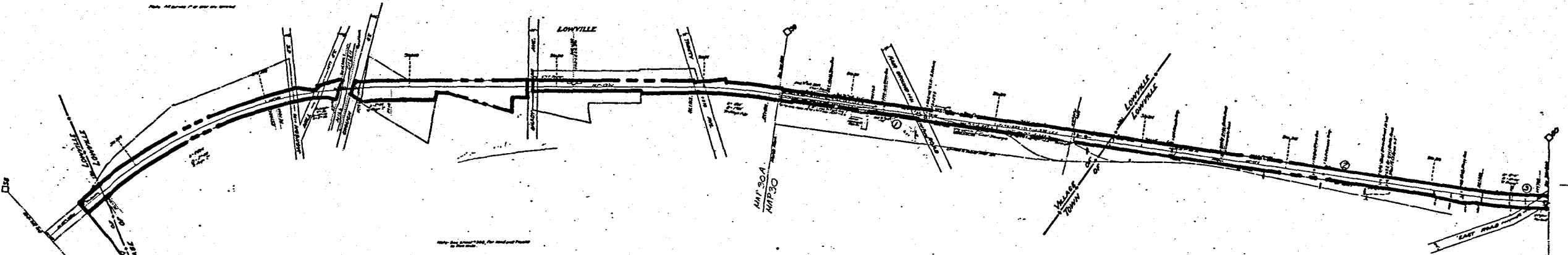

BEGIN L.C. 4751  
STA. 306+58.1  
M.P. 58.1

--- PROPERTY TO BE CONVEYED  
BY  
CONSOLIDATED RAIL CORPORATION  
TO  
MOHAWK, ADIRONDACK &  
NORTHERN RAILROAD CORPORATION

NO.	DATE	BY	DESCRIPTION	REVISION
1	10/20/58	J. S. B. A. S. B.	Initial	0-11
2	11/10/58	J. S. B. A. S. B.	Revised to show	0-21
3	12/10/58	J. S. B. A. S. B.	Revised to show	0-31

RIGHT OF WAY AND TRACK MAP  
NEW YORK CENTRAL RAILROAD  
Operated by  
THE NEW YORK CENTRAL RAILROAD COMPANY  
MAIN LINE - OGDENSBURG BRANCH  
LOWVILLE  
From Sta. 300-340 to Sta. 300-300  
1 inch = 200 feet  
Revised to 12/21/58

LOWVILLE  
LEWIS CO.  
NEW YORK

41 21758.0-58.1 L.C. 4751 58.1-60





# CARTHAGE

# LOWVILLE INDUSTRIAL TRACK & NEWTON FALLS SECONDARY

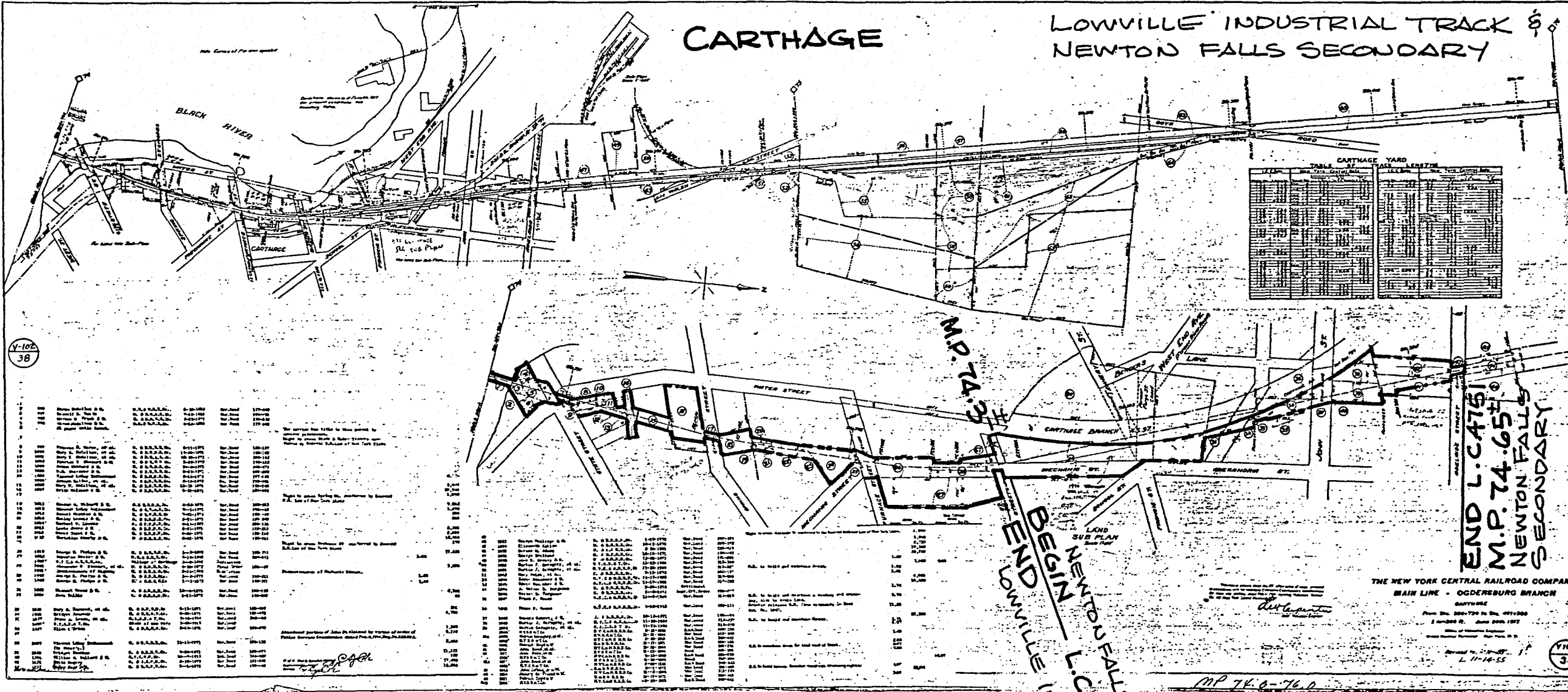

CARTHAGE YARD	
TABLE	TRACKS
1	1
2	2
3	3
4	4
5	5
6	6
7	7
8	8
9	9
10	10
11	11
12	12
13	13
14	14
15	15
16	16
17	17
18	18
19	19
20	20
21	21
22	22
23	23
24	24
25	25
26	26
27	27
28	28
29	29
30	30
31	31
32	32
33	33
34	34
35	35
36	36
37	37
38	38
39	39
40	40
41	41
42	42
43	43
44	44
45	45
46	46
47	47
48	48
49	49
50	50
51	51
52	52
53	53
54	54
55	55
56	56
57	57
58	58
59	59
60	60
61	61
62	62
63	63
64	64
65	65
66	66
67	67
68	68
69	69
70	70
71	71
72	72
73	73
74	74
75	75
76	76
77	77
78	78
79	79
80	80
81	81
82	82
83	83
84	84
85	85
86	86
87	87
88	88
89	89
90	90
91	91
92	92
93	93
94	94
95	95
96	96
97	97
98	98
99	99
100	100

V-102  
38

Station	Track	Structure	Notes
0+00	1	...	...
0+10	1	...	...
0+20	1	...	...
0+30	1	...	...
0+40	1	...	...
0+50	1	...	...
0+60	1	...	...
0+70	1	...	...
0+80	1	...	...
0+90	1	...	...
1+00	1	...	...
1+10	1	...	...
1+20	1	...	...
1+30	1	...	...
1+40	1	...	...
1+50	1	...	...
1+60	1	...	...
1+70	1	...	...
1+80	1	...	...
1+90	1	...	...
2+00	1	...	...
2+10	1	...	...
2+20	1	...	...
2+30	1	...	...
2+40	1	...	...
2+50	1	...	...
2+60	1	...	...
2+70	1	...	...
2+80	1	...	...
2+90	1	...	...
3+00	1	...	...
3+10	1	...	...
3+20	1	...	...
3+30	1	...	...
3+40	1	...	...
3+50	1	...	...
3+60	1	...	...
3+70	1	...	...
3+80	1	...	...
3+90	1	...	...
4+00	1	...	...
4+10	1	...	...
4+20	1	...	...
4+30	1	...	...
4+40	1	...	...
4+50	1	...	...
4+60	1	...	...
4+70	1	...	...
4+80	1	...	...
4+90	1	...	...
5+00	1	...	...
5+10	1	...	...
5+20	1	...	...
5+30	1	...	...
5+40	1	...	...
5+50	1	...	...
5+60	1	...	...
5+70	1	...	...
5+80	1	...	...
5+90	1	...	...
6+00	1	...	...
6+10	1	...	...
6+20	1	...	...
6+30	1	...	...
6+40	1	...	...
6+50	1	...	...
6+60	1	...	...
6+70	1	...	...
6+80	1	...	...
6+90	1	...	...
7+00	1	...	...
7+10	1	...	...
7+20	1	...	...
7+30	1	...	...
7+40	1	...	...
7+50	1	...	...
7+60	1	...	...
7+70	1	...	...
7+80	1	...	...
7+90	1	...	...
8+00	1	...	...
8+10	1	...	...
8+20	1	...	...
8+30	1	...	...
8+40	1	...	...
8+50	1	...	...
8+60	1	...	...
8+70	1	...	...
8+80	1	...	...
8+90	1	...	...
9+00	1	...	...
9+10	1	...	...
9+20	1	...	...
9+30	1	...	...
9+40	1	...	...
9+50	1	...	...
9+60	1	...	...
9+70	1	...	...
9+80	1	...	...
9+90	1	...	...
10+00	1	...	...

M.P. 74.65  
 BEGIN NEWTON FALLS SECONDARY  
 END L.C. 4751  
 LOWVILLE IND. TRACK

THE NEW YORK CENTRAL RAILROAD COMPANY  
 MAIN LINE - OGDERSBURG BRANCH  
 CARTHAGE  
 From Sta. 200-720 to Sta. 497-000  
 1 mi. 200 ft. June 24th 1917  
 L 11-14-55

NOTE: CONRAIL RESERVING UTILITY EASEMENTS.

V102  
38

BEGIN L.C. 4752  
M.P. 29±

NEWTON FALLS  
SECONDARY

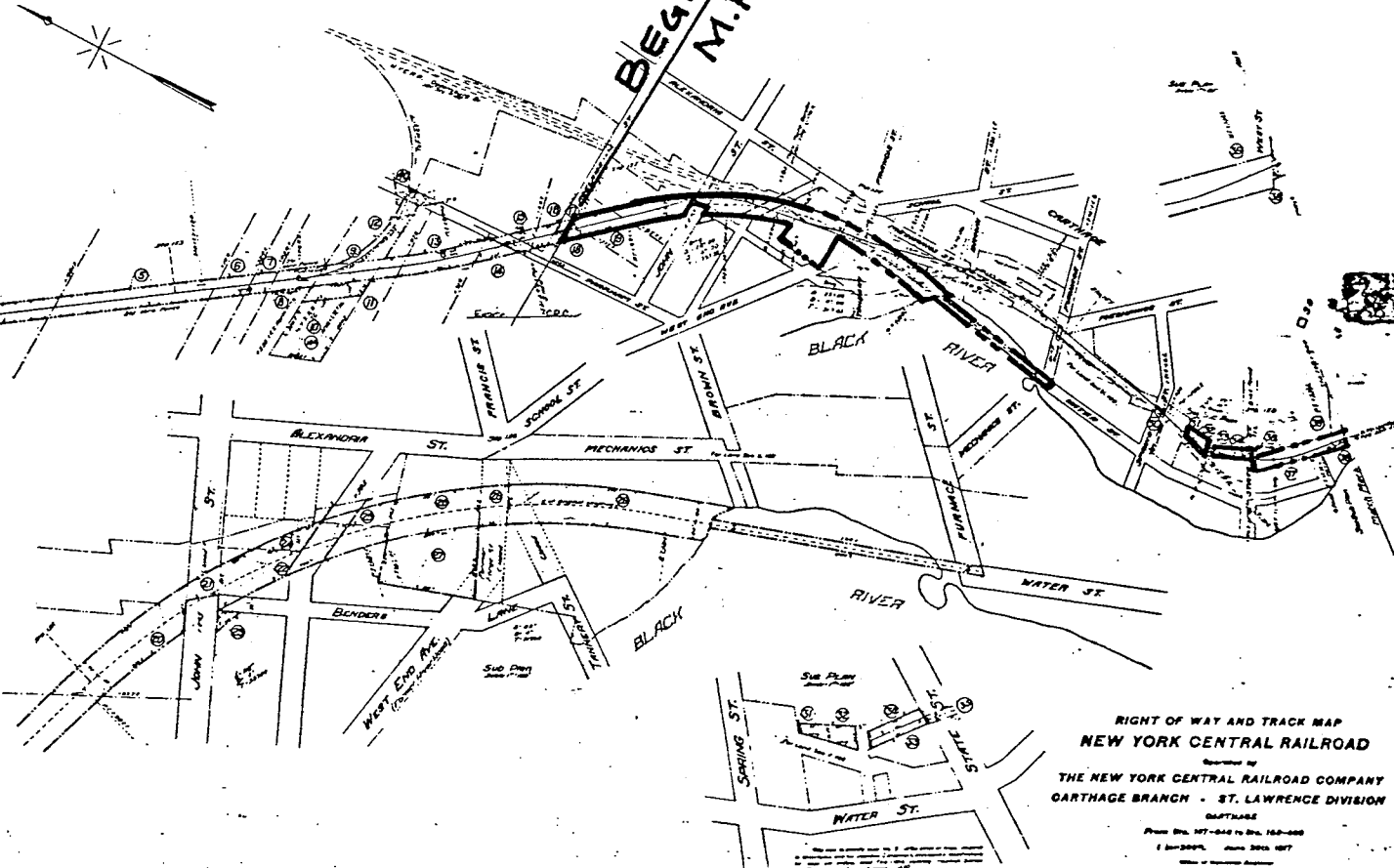

INDEX OF THE SHEETS

Sheet No.	Section	Block	Owner	Remarks
101	101	101	101	101
102	102	102	102	102
103	103	103	103	103
104	104	104	104	104
105	105	105	105	105
106	106	106	106	106
107	107	107	107	107
108	108	108	108	108
109	109	109	109	109
110	110	110	110	110
111	111	111	111	111
112	112	112	112	112
113	113	113	113	113
114	114	114	114	114
115	115	115	115	115
116	116	116	116	116
117	117	117	117	117
118	118	118	118	118
119	119	119	119	119
120	120	120	120	120
121	121	121	121	121
122	122	122	122	122
123	123	123	123	123
124	124	124	124	124
125	125	125	125	125
126	126	126	126	126
127	127	127	127	127
128	128	128	128	128
129	129	129	129	129
130	130	130	130	130
131	131	131	131	131
132	132	132	132	132
133	133	133	133	133
134	134	134	134	134
135	135	135	135	135
136	136	136	136	136
137	137	137	137	137
138	138	138	138	138
139	139	139	139	139
140	140	140	140	140
141	141	141	141	141
142	142	142	142	142
143	143	143	143	143
144	144	144	144	144
145	145	145	145	145
146	146	146	146	146
147	147	147	147	147
148	148	148	148	148
149	149	149	149	149
150	150	150	150	150

RIGHT OF WAY AND TRACK MAP  
NEW YORK CENTRAL RAILROAD  
Operated by  
THE NEW YORK CENTRAL RAILROAD COMPANY  
GARTHAGE BRANCH - ST. LAWRENCE DIVISION  
GARTHAGE  
Printed by THE NEW YORK CENTRAL RAILROAD COMPANY  
100 N. 3rd St., New York, N.Y.  
1917

JEFFERSON CO.

107  
7

107 0970 10 4752 177 01-36.0

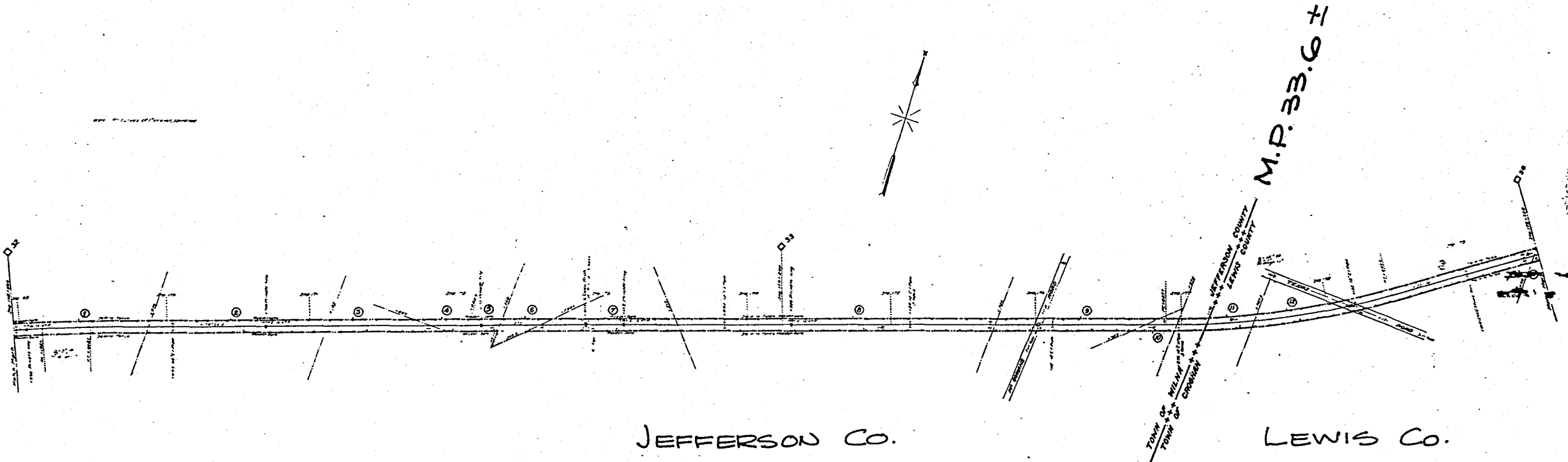

ALIAS DE WAS SCHEDULE  
TYPE OF CLASS  
NAME OF CLASS

COUNTY OF JEFFERSON  
STATE OF NEW YORK

Lot	Grade	Area	Volume	Date	Conveyance	Notes	Comments & Remarks	Area
1	1.00			01-17-1888	01-1888			1.00
2	1.00			01-17-1888	01-1888			1.00
3	1.00			01-17-1888	01-1888			1.00
4	1.00			01-17-1888	01-1888			1.00
5	1.00			01-17-1888	01-1888			1.00
6	1.00			01-17-1888	01-1888			1.00
7	1.00			01-17-1888	01-1888			1.00
8	1.00			01-17-1888	01-1888			1.00
9	1.00			01-17-1888	01-1888			1.00
10	1.00			01-17-1888	01-1888			1.00
11	1.00			01-17-1888	01-1888			1.00
12	1.00			01-17-1888	01-1888			1.00
13	1.00			01-17-1888	01-1888			1.00
14	1.00			01-17-1888	01-1888			1.00
15	1.00			01-17-1888	01-1888			1.00
16	1.00			01-17-1888	01-1888			1.00
17	1.00			01-17-1888	01-1888			1.00
18	1.00			01-17-1888	01-1888			1.00
19	1.00			01-17-1888	01-1888			1.00
20	1.00			01-17-1888	01-1888			1.00
21	1.00			01-17-1888	01-1888			1.00
22	1.00			01-17-1888	01-1888			1.00
23	1.00			01-17-1888	01-1888			1.00
24	1.00			01-17-1888	01-1888			1.00
25	1.00			01-17-1888	01-1888			1.00
26	1.00			01-17-1888	01-1888			1.00
27	1.00			01-17-1888	01-1888			1.00
28	1.00			01-17-1888	01-1888			1.00
29	1.00			01-17-1888	01-1888			1.00
30	1.00			01-17-1888	01-1888			1.00
31	1.00			01-17-1888	01-1888			1.00
32	1.00			01-17-1888	01-1888			1.00
33	1.00			01-17-1888	01-1888			1.00
34	1.00			01-17-1888	01-1888			1.00
35	1.00			01-17-1888	01-1888			1.00
36	1.00			01-17-1888	01-1888			1.00
37	1.00			01-17-1888	01-1888			1.00
38	1.00			01-17-1888	01-1888			1.00
39	1.00			01-17-1888	01-1888			1.00
40	1.00			01-17-1888	01-1888			1.00
41	1.00			01-17-1888	01-1888			1.00
42	1.00			01-17-1888	01-1888			1.00
43	1.00			01-17-1888	01-1888			1.00
44	1.00			01-17-1888	01-1888			1.00
45	1.00			01-17-1888	01-1888			1.00
46	1.00			01-17-1888	01-1888			1.00
47	1.00			01-17-1888	01-1888			1.00
48	1.00			01-17-1888	01-1888			1.00
49	1.00			01-17-1888	01-1888			1.00
50	1.00			01-17-1888	01-1888			1.00
51	1.00			01-17-1888	01-1888			1.00
52	1.00			01-17-1888	01-1888			1.00
53	1.00			01-17-1888	01-1888			1.00
54	1.00			01-17-1888	01-1888			1.00
55	1.00			01-17-1888	01-1888			1.00
56	1.00			01-17-1888	01-1888			1.00
57	1.00			01-17-1888	01-1888			1.00
58	1.00			01-17-1888	01-1888			1.00
59	1.00			01-17-1888	01-1888			1.00
60	1.00			01-17-1888	01-1888			1.00
61	1.00			01-17-1888	01-1888			1.00
62	1.00			01-17-1888	01-1888			1.00
63	1.00			01-17-1888	01-1888			1.00
64	1.00			01-17-1888	01-1888			1.00
65	1.00			01-17-1888	01-1888			1.00
66	1.00			01-17-1888	01-1888			1.00
67	1.00			01-17-1888	01-1888			1.00
68	1.00			01-17-1888	01-1888			1.00
69	1.00			01-17-1888	01-1888			1.00
70	1.00			01-17-1888	01-1888			1.00
71	1.00			01-17-1888	01-1888			1.00
72	1.00			01-17-1888	01-1888			1.00
73	1.00			01-17-1888	01-1888			1.00
74	1.00			01-17-1888	01-1888			1.00
75	1.00			01-17-1888	01-1888			1.00
76	1.00			01-17-1888	01-1888			1.00
77	1.00			01-17-1888	01-1888			1.00
78	1.00			01-17-1888	01-1888			1.00
79	1.00			01-17-1888	01-1888			1.00
80	1.00			01-17-1888	01-1888			1.00
81	1.00			01-17-1888	01-1888			1.00
82	1.00			01-17-1888	01-1888			1.00
83	1.00			01-17-1888	01-1888			1.00
84	1.00			01-17-1888	01-1888			1.00
85	1.00			01-17-1888	01-1888			1.00
86	1.00			01-17-1888	01-1888			1.00
87	1.00			01-17-1888	01-1888			1.00
88	1.00			01-17-1888	01-1888			1.00
89	1.00			01-17-1888	01-1888			1.00
90	1.00			01-17-1888	01-1888			1.00
91	1.00			01-17-1888	01-1888			1.00
92	1.00			01-17-1888	01-1888			1.00
93	1.00			01-17-1888	01-1888			1.00
94	1.00			01-17-1888	01-1888			1.00
95	1.00			01-17-1888	01-1888			1.00
96	1.00			01-17-1888	01-1888			1.00
97	1.00			01-17-1888	01-1888			1.00
98	1.00			01-17-1888	01-1888			1.00
99	1.00			01-17-1888	01-1888			1.00
100	1.00			01-17-1888	01-1888			1.00

RIGHT OF WAY AND TRACK MAP  
NEW YORK CENTRAL RAILROAD  
Operated by  
THE NEW YORK CENTRAL RAILROAD COMPANY  
CARTHAGE BRANCH - ST LAWRENCE DIVISION

THE NEW YORK CENTRAL RAILROAD COMPANY  
CARTHAGE BRANCH - ST LAWRENCE DIVISION  
CARTHAGE - WILMINGTON  
From Sta. 100-000 to Sta. 170-000  
1:25000 N. 1900 1917  
Scale of Horizontal Distances  
Scale of Vertical Distances  
Copyright 1917 by The New York Central Railroad Company

YS 0970 R 4752 17.0 32.0-3-

Y-97  
11

Y-97  
11





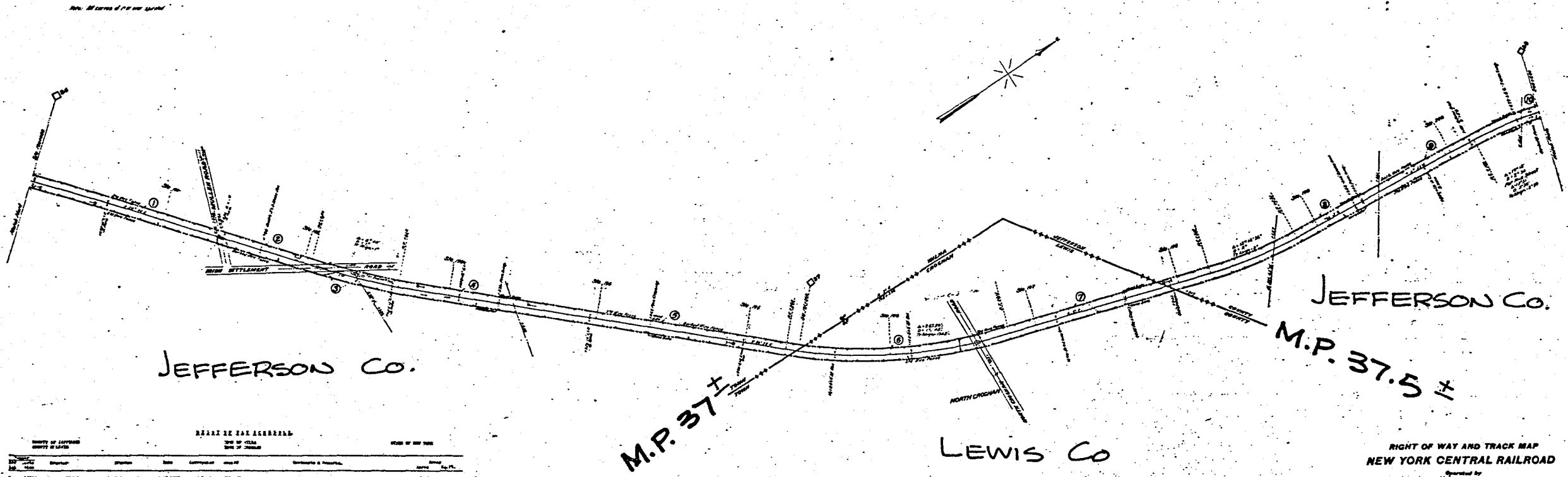

PROPERTY OF JEFFERSON COUNTY, MISSOURI

REARER TAX ASSESSMENT

STATE OF MISSOURI

YEAR OF TAX 1917

Tract No.	Owner	Area	Class	Assessment	Remarks	Area
1	A. L. & W. L. ...	...	...	...	...	...
2	A. L. & W. L. ...	...	...	...	...	...
3	A. L. & W. L. ...	...	...	...	...	...
4	A. L. & W. L. ...	...	...	...	...	...
5	A. L. & W. L. ...	...	...	...	...	...
6	A. L. & W. L. ...	...	...	...	...	...
7	A. L. & W. L. ...	...	...	...	...	...
8	A. L. & W. L. ...	...	...	...	...	...
9	A. L. & W. L. ...	...	...	...	...	...
10	A. L. & W. L. ...	...	...	...	...	...
11	A. L. & W. L. ...	...	...	...	...	...
12	A. L. & W. L. ...	...	...	...	...	...
13	A. L. & W. L. ...	...	...	...	...	...
14	A. L. & W. L. ...	...	...	...	...	...
15	A. L. & W. L. ...	...	...	...	...	...
16	A. L. & W. L. ...	...	...	...	...	...
17	A. L. & W. L. ...	...	...	...	...	...
18	A. L. & W. L. ...	...	...	...	...	...
19	A. L. & W. L. ...	...	...	...	...	...
20	A. L. & W. L. ...	...	...	...	...	...
21	A. L. & W. L. ...	...	...	...	...	...
22	A. L. & W. L. ...	...	...	...	...	...
23	A. L. & W. L. ...	...	...	...	...	...
24	A. L. & W. L. ...	...	...	...	...	...
25	A. L. & W. L. ...	...	...	...	...	...
26	A. L. & W. L. ...	...	...	...	...	...
27	A. L. & W. L. ...	...	...	...	...	...
28	A. L. & W. L. ...	...	...	...	...	...
29	A. L. & W. L. ...	...	...	...	...	...
30	A. L. & W. L. ...	...	...	...	...	...
31	A. L. & W. L. ...	...	...	...	...	...
32	A. L. & W. L. ...	...	...	...	...	...
33	A. L. & W. L. ...	...	...	...	...	...
34	A. L. & W. L. ...	...	...	...	...	...
35	A. L. & W. L. ...	...	...	...	...	...
36	A. L. & W. L. ...	...	...	...	...	...
37	A. L. & W. L. ...	...	...	...	...	...
38	A. L. & W. L. ...	...	...	...	...	...
39	A. L. & W. L. ...	...	...	...	...	...
40	A. L. & W. L. ...	...	...	...	...	...
41	A. L. & W. L. ...	...	...	...	...	...
42	A. L. & W. L. ...	...	...	...	...	...
43	A. L. & W. L. ...	...	...	...	...	...
44	A. L. & W. L. ...	...	...	...	...	...
45	A. L. & W. L. ...	...	...	...	...	...
46	A. L. & W. L. ...	...	...	...	...	...
47	A. L. & W. L. ...	...	...	...	...	...
48	A. L. & W. L. ...	...	...	...	...	...
49	A. L. & W. L. ...	...	...	...	...	...
50	A. L. & W. L. ...	...	...	...	...	...

RIGHT OF WAY AND TRACK MAP  
NEW YORK CENTRAL RAILROAD  
Operated by  
THE NEW YORK CENTRAL RAILROAD COMPANY  
GARTHAGE BRANCH - ST. LAWRENCE DIVISION

From Map 170-000 to No. 200-000  
7 Jan 1917, June 1917  
Revised to LC-35

V-37  
13

V87  
13

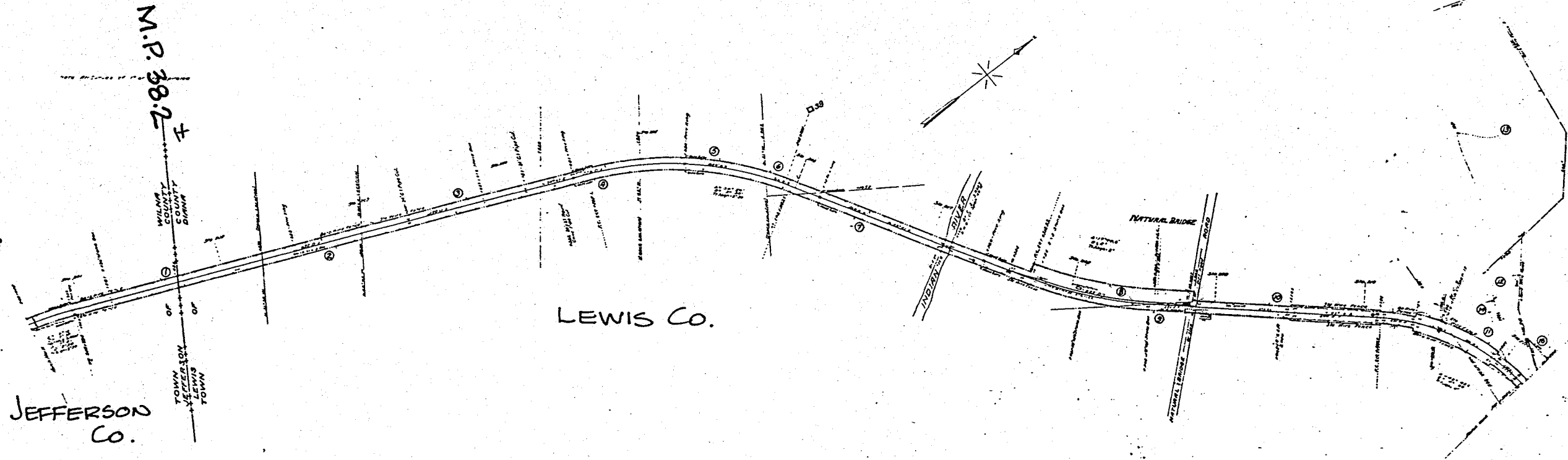

Changes since June 23, 1916

RIGHT OF WAY SCHEDULE

STATE OF NEW YORK

COUNTY OF JEFFERSON

TOWN OF LEWIS

APC	BY	DATE	GRANTOR	GRANTEE	DATE	CONVEYANCE	RECORD	COMMENTS & REMARKS	ACTS	Sq. Ft.
1	1776	1776	Caroline Funder	C. & A. R. Co.	1847-1848	Warrant	1847-1848	R.R. to build a station on line that four crossings	2.17	
2	1776	1776	Caroline Funder	C. & A. R. Co.	1847-1848	Warrant	1847-1848	R.R. to build a station on line that four crossings	1.18	
3	1776	1776	Caroline Funder	C. & A. R. Co.	1847-1848	Warrant	1847-1848	R.R. to build a station on line that four crossings	1.18	
4	1776	1776	Caroline Funder	C. & A. R. Co.	1847-1848	Warrant	1847-1848	R.R. to build a station on line that four crossings	1.18	
5	1776	1776	Caroline Funder	C. & A. R. Co.	1847-1848	Warrant	1847-1848	R.R. to build a station on line that four crossings	1.18	
6	1776	1776	Caroline Funder	C. & A. R. Co.	1847-1848	Warrant	1847-1848	R.R. to build a station on line that four crossings	1.18	
7	1776	1776	Caroline Funder	C. & A. R. Co.	1847-1848	Warrant	1847-1848	R.R. to build a station on line that four crossings	1.18	
8	1776	1776	Caroline Funder	C. & A. R. Co.	1847-1848	Warrant	1847-1848	R.R. to build a station on line that four crossings	1.18	
9	1776	1776	Caroline Funder	C. & A. R. Co.	1847-1848	Warrant	1847-1848	R.R. to build a station on line that four crossings	1.18	
10	1776	1776	Caroline Funder	C. & A. R. Co.	1847-1848	Warrant	1847-1848	R.R. to build a station on line that four crossings	1.18	
11	1776	1776	Caroline Funder	C. & A. R. Co.	1847-1848	Warrant	1847-1848	R.R. to build a station on line that four crossings	1.18	
12	1776	1776	Caroline Funder	C. & A. R. Co.	1847-1848	Warrant	1847-1848	R.R. to build a station on line that four crossings	1.18	
13	1776	1776	Caroline Funder	C. & A. R. Co.	1847-1848	Warrant	1847-1848	R.R. to build a station on line that four crossings	1.18	
14	1776	1776	Caroline Funder	C. & A. R. Co.	1847-1848	Warrant	1847-1848	R.R. to build a station on line that four crossings	1.18	
15	1776	1776	Caroline Funder	C. & A. R. Co.	1847-1848	Warrant	1847-1848	R.R. to build a station on line that four crossings	1.18	
16	1776	1776	Caroline Funder	C. & A. R. Co.	1847-1848	Warrant	1847-1848	R.R. to build a station on line that four crossings	1.18	
17	1776	1776	Caroline Funder	C. & A. R. Co.	1847-1848	Warrant	1847-1848	R.R. to build a station on line that four crossings	1.18	
18	1776	1776	Caroline Funder	C. & A. R. Co.	1847-1848	Warrant	1847-1848	R.R. to build a station on line that four crossings	1.18	
19	1776	1776	Caroline Funder	C. & A. R. Co.	1847-1848	Warrant	1847-1848	R.R. to build a station on line that four crossings	1.18	
20	1776	1776	Caroline Funder	C. & A. R. Co.	1847-1848	Warrant	1847-1848	R.R. to build a station on line that four crossings	1.18	

RIGHT OF WAY AND TRACK MAP  
 NEW YORK CENTRAL RAILROAD  
 THE NEW YORK CENTRAL RAILROAD COMPANY  
 CARTHAGE BRANCH - ST. LAWRENCE DIVISION

Printed by  
 THE NEW YORK CENTRAL RAILROAD COMPANY  
 CARTHAGE BRANCH - ST. LAWRENCE DIVISION  
 CARTHAGE, N. Y.

Y5 075 LC 4752 MP 380-462



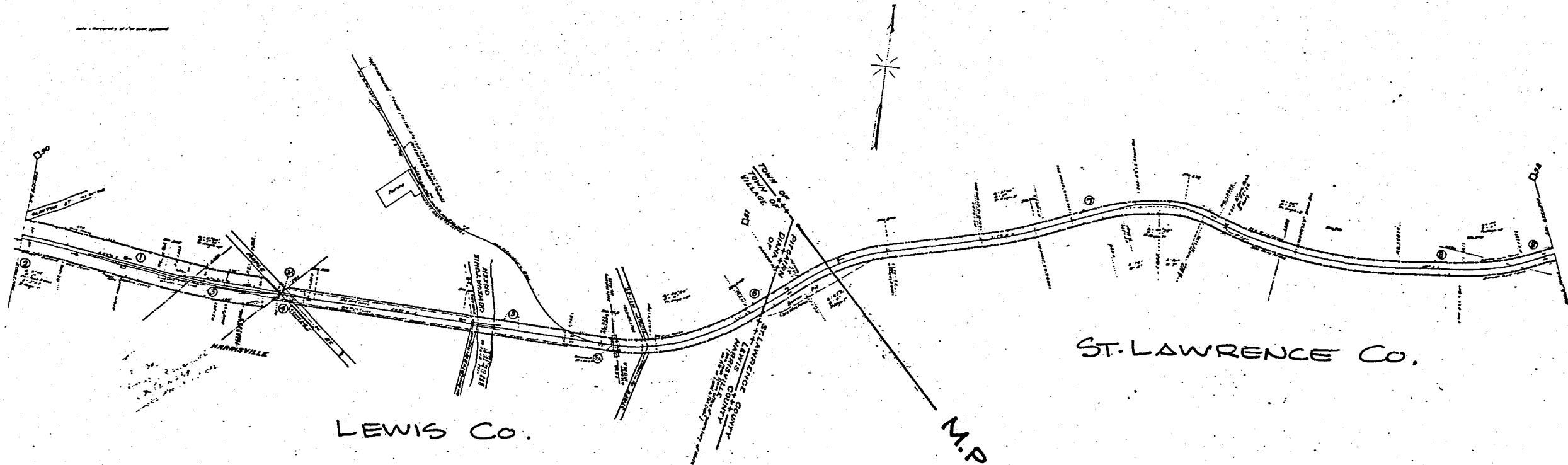

**REPORT OF TAX RECEIPTS**

STATE OF NEW YORK  
COUNTY OF ST. LAWRENCE

No.	Name	Address	Rate	Amount	Comments & Remarks
1	Charles W. Bond & Co.	C. W. Bond, Jr., St. Lawrence, N. Y.	0-10-000	100.00	
2	John C. Bond, Jr.	C. W. Bond, Jr., St. Lawrence, N. Y.	0-10-000	100.00	
3	Augustus Bond, Jr.	C. W. Bond, Jr., St. Lawrence, N. Y.	0-10-000	100.00	
4	John C. Bond, Jr.	C. W. Bond, Jr., St. Lawrence, N. Y.	0-10-000	100.00	
5	Thomas E. Bond, Jr.	C. W. Bond, Jr., St. Lawrence, N. Y.	0-10-000	100.00	
6	Henry Bond, Jr.	C. W. Bond, Jr., St. Lawrence, N. Y.	0-10-000	100.00	
7	William Bond, Jr.	C. W. Bond, Jr., St. Lawrence, N. Y.	0-10-000	100.00	
8	James E. Bond, Jr.	C. W. Bond, Jr., St. Lawrence, N. Y.	0-10-000	100.00	
9	Henry E. Bond, Jr.	C. W. Bond, Jr., St. Lawrence, N. Y.	0-10-000	100.00	
10	James E. Bond, Jr.	C. W. Bond, Jr., St. Lawrence, N. Y.	0-10-000	100.00	

ST. LAWRENCE CO.

LEWIS CO.

M.P. 51 1/2

RIGHT OF WAY AND TRACK MAP  
NEW YORK CENTRAL RAILROAD  
Operated by  
THE NEW YORK CENTRAL RAILROAD COMPANY  
CARTHAGE BRANCH - ST. LAWRENCE DIVISION  
HARRISVILLE

Scale: 1" = 200' - 0" to Sta. 574+00  
1" = 200' - 0" to Sta. 574+00  
Date of Revision: 1917  
Drawn by: [Signature]  
Checked by: [Signature]

V-97  
20

V97  
20

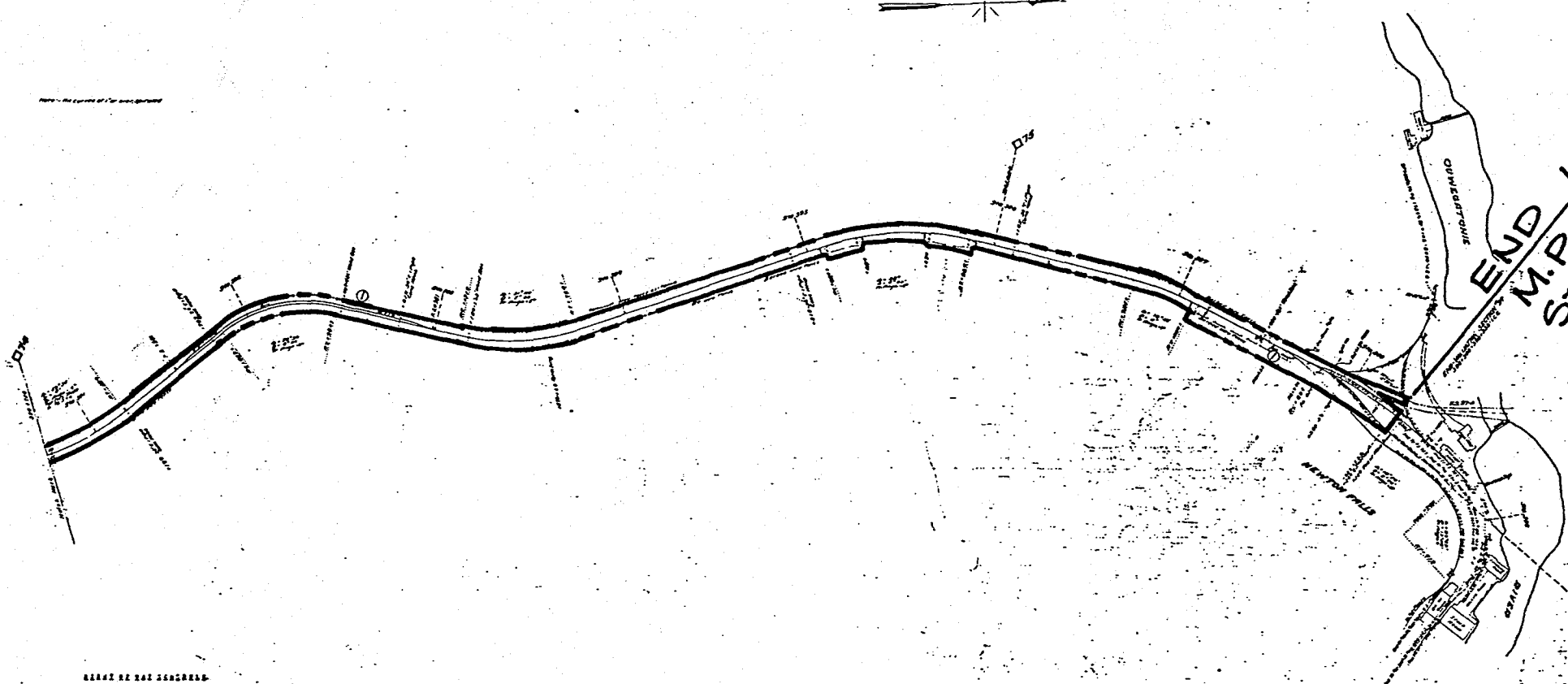
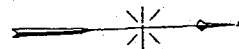

END L.C. 4752  
M.P. 75.4 ±  
STA. 398+309

RIGHT OF WAY AND TRACK MAP  
NEW YORK CENTRAL RAILROAD  
THE NEW YORK CENTRAL RAILROAD COMPANY  
CARTHAGE BRANCH - ST. LAWRENCE DIVISION  
NEWTON FALLS

SCALE OF THE MAP

Scale	Feet	Meters	Scale	Feet	Meters
1" = 100'	30.48	9.14	1" = 200'	60.96	18.28
1" = 300'	91.44	27.43	1" = 400'	121.92	37.17
1" = 500'	152.88	46.57	1" = 600'	182.88	55.75
1" = 800'	244.64	74.50	1" = 1000'	304.80	92.66

32

32

Y'S 0970 LC 4752 HP 74.0-75.4



LEWIS COUNTY - STATE OF NEW YORK  
 LINDA D. HOSKINS, LEWIS COUNTY CLERK  
 P.O. BOX 232, LOWVILLE, NEW YORK 13367

COUNTY CLERK'S RECORDING PAGE  
 \*\*\*THIS PAGE IS PART OF THE DOCUMENT - DO NOT DETACH\*\*\*



INSTRUMENT #: 2016-004462

Receipt#: 2016131878  
 Clerk: CS  
 Rec Date: 08/29/2016 10:05:59 AM  
 Doc Grp: RP  
 Descrip: DEED  
 Num Pgs: 18

Party1: COUNTY OF LEWIS INDUSTRIAL  
 DEVELOPMENT AGENCY  
 Party2: LOWVILLE AND BEAVER RIVER  
 RAILROAD COMPANY  
 Town: CROGHAN  
 LOWVILLE  
 NEW BREMEN  
 DENMARK

Recording:

Cover Page	5.00
Recording Fee	105.00
Cultural Ed	14.25
Records Management - Coun	1.00
Records Management - Stat	4.75
TP584	5.00
RP5217 - County	9.00
RP5217 All others - State	241.00

Sub Total: 385.00

Transfer Tax  
 Transfer Tax 0.00

Sub Total: 0.00

Total: 385.00

\*\*\*\* NOTICE: THIS IS NOT A BILL \*\*\*\*

\*\*\*\*\* Transfer Tax \*\*\*\*\*  
 Transfer Tax #: 123  
 Transfer Tax  
 Consideration: 0.00

Total: 0.00

Record and Return To:

GENESEE VALLEY TRANSPORTATION CO INC  
 ONE MILL ST., SUITE 101  
 BATAVIA, NY 14020

Linda D. Hoskins  
 Lewis County Clerk

## QUITCLAIM DEED

THIS QUITCLAIM DEED, made the 14<sup>th</sup> day of ~~June~~<sup>July</sup> Two Thousand Sixteen (2016), is

BETWEEN COUNTY OF LEWIS INDUSTRIAL DEVELOPMENT AGENCY, a corporate governmental agency constituting a body corporate and politic and a public benefit corporation of the County of Lewis, State of New York, having its principal office at 7642 South State St., Lowville, New York 13367, hereinafter referred to as the GRANTOR, and THE LOWVILLE AND BEAVER RIVER RAILROAD COMPANY, a corporation organized and existing under the law of the State of New York, having an office at One Mill St., Suite 100, Batavia, New York 14020, hereinafter referred to as the GRANTEE.

WITNESSETH: that GRANTOR, for and in consideration of the sum of ONE DOLLAR (\$1.00), lawful money of the United States, and other good and valuable consideration, paid by GRANTEE, the receipt whereof is hereby acknowledged, does hereby remise, release, and quitclaim unto GRANTEE and its successors and assigns forever, all right, title and interest of GRANTOR of, in and to the real property described in the attached Exhibit A, Items 1-85, and excepting Exhibit A, Items 86-107, and made a part hereof by this reference (the "Premises"), together with the appurtenances and all the estate and rights of the Grantor in and to the Premises, being all of that property transferred by Grantee to Grantor by Indenture recorded on January 31, 1991 in the Lewis County Clerk's Office beginning at Page 301 of Book 531 of Deeds.

TO HAVE AND TO HOLD the Premises, together with the improvements and appurtenances thereon, herein remised, released and quitclaimed unto the GRANTEE, and provided as aforesaid.

*~SIGNATURE PAGE NEXT~*

IN WITNESS WHEREOF, the Grantor has caused these presents to be signed by its duly authorized officer the day and year first above written.

COUNTY OF LEWIS INDUSTRIAL DEVELOPMENT AGENCY

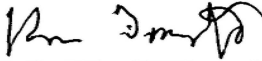
By:   
Roscoe Fawcett  
Chairman of the Board

STATE OF NEW YORK            )  
COUNTY OF LEWIS            )

On this 14<sup>th</sup> day of ~~June~~<sup>July</sup> 2016 before me, the undersigned, personally appeared Roscoe Fawcett personally known to me or proved to me on the basis of satisfactory evidence to be the individual whose name is subscribed to the within instrument and acknowledged to me that he executed the same in his capacity, and that by his signature on the instrument, the individual, or the person upon behalf of which the individual acted, executed the instrument.

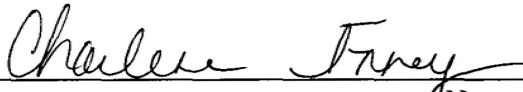
  
Notary Public

CHARLENE FORNEY  
Notary Public, State of New York  
No. 01FO6255492  
Qualified in Lewis County  
Commission Expires March 26, 2020

EXHIBIT A

All that tract or parcel of land situate in the Town and Village of Lowville, the Town of New Bremen and the Town and Village of Croghan, County of Lewis, State of New York, more particularly described in the following deeds, rights-of-way, notices of appropriation, and agreement:

1. Sarah M. Kilts to the Lowville and Beaver River Railroad Company, dated February 8, 1905, recorded in the Lewis County Clerk's office on March 24, 1905, in Book 108 of Deeds at page 434.
2. Ira Sharp and Ella S. Sharp to the Lowville and Beaver River Railroad Company, dated January 17, 1905, recorded in the Lewis County Clerk's office on March 24, 1905, in Book 108 of Deeds at page 435.
3. Nicholas Kirschner and Rose Kirschner (his wife) to the Lowville and Beaver River Railroad Company, dated January 31, 1905, recorded in the Lewis County Clerk's office on March 24, 1905, in Book 108 of Deeds at page 437.
4. Levi H. Andrus and Lida Andrus (his wife) to the Lowville and Beaver River Railroad Company, dated January 14, 1905, recorded in the Lewis County Clerk's office on March 24, 1905, in Book 108 of Deeds at page 438.
5. John Sauer and Margery A. Sauer (his wife) to the Lowville and Beaver River Railroad Company, dated January 6, 1905, recorded in the Lewis County Clerk's office on March 24, 1905, in Book 108 of Deeds at page 439.
6. Vincent N. Tisse and Grace B. Tisse to the Lowville and Beaver River Railroad Company, dated January 31, 1905, recorded in the Lewis County Clerk's office on March 24, 1905, in Book 108 of Deeds at page 440.
7. Albert Van Atter and Jan Van Atter (his wife) to the Lowville and Beaver River Railroad Company, dated February 21, 1905, recorded in the Lewis County Clerk's office on March 24, 1905, in Book 108 of Deeds at page 442.



8. William Holzworth to the Lowville and Beaver River Railroad Company, dated March 2, 1905, recorded in the Lewis County Clerk's office on March 24, 1905, in Book 108 of Deeds at page 443.

9. William T. Illingsworth and Agnes Illingsworth (his wife) to the Lowville and Beaver River Railroad Company, dated January 31, 1905, recorded in the Lewis County Clerk's office on March 24, 1905, in Book 108 of Deeds at page 444.

10. Louise E. Waterhouse to the Lowville and Beaver River Railroad Company, dated November 21, 1904, recorded in the Lewis County Clerk's office on March 24, 1905, in Book 108 of Deeds at page 445.

11. Elizabeth Valin to the Lowville and Beaver River Railroad Company, dated November 21, 1904, recorded in the Lewis County Clerk's office on March 24, 1905, in Book 108 of Deeds at page 446.

12. Joseph E. Ebersoll and Catharine Ebersoll to the Lowville and Beaver River Railroad Company, dated December 20, 1904, recorded in the Lewis County Clerk's office on March 24, 1905, in Book 108 of Deeds at page 447.

13. Margaret Brandley to the Lowville and Beaver River Railroad Company, dated December 20, 1904, recorded in the Lewis County Clerk's office on March 24, 1905, in Book 108 of Deeds at page 448.

14. William Mullen and Maryan Mullen (his wife) to the Lowville and Beaver River Railroad Company, dated December 22, 1904, recorded in the Lewis County Clerk's office on March 24, 1905, in Book 108 of Deeds at page 449.

15. Martha Dupuy to the Lowville and Beaver River Railroad Company, dated December 22, 1904, recorded in the Lewis County Clerk's office on March 24, 1905, in Book 108 of Deeds at page 450.

16. Christopher Everard and Annie M. Everard (his wife) to the Lowville and Beaver River Railroad Company, dated December 20, 1904, recorded in the Lewis County Clerk's office on March 24, 1905, in Book 108 of Deeds at page 451.

17. Thomas E. Williams and Ida M. Williams (his wife) to the Lowville and Beaver River Railroad Company, dated December 26, 1904, recorded in the Lewis County Clerk's office on March 24, 1905, in Book 108 of Deeds at page 453.

18. Christopher Everard and Annie M. Everard (his wife) and Frank Everard and Catherine Everard (his wife) to the Lowville and Beaver River Railroad Company, dated December 26, 1904, recorded in the Lewis County Clerk's office on March 24, 1905, in Book 108 of Deeds at page 455.

19. Elizabeth Calligan to the Lowville and Beaver River Railroad Company, dated December 26, 1904, recorded in the Lewis County Clerk's office on March 24, 1905, in Book 108 of Deeds at page 456.

20. Elizabeth Colligan (widow), Katherine Slack, Mary Colligan, Marcella Colligan, Edward W. Colligan, children and only heirs at Law of Christopher Colligan, deceased, and Annie Bourgeois to the Lowville and Beaver River Railroad Company, dated November 21, 1904, recorded in the Lewis County Clerk's office on March 24, 1905, in Book 108 of Deeds at page 457.

21. Emma Sauer to the Lowville and Beaver River Railroad Company, dated December 29, 1904, recorded in the Lewis County Clerk's office on March 24, 1905, in Book 108 of Deeds at page 459.

22. Hattie La Mourey and Anna J. Higby to the Lowville and Beaver River Railroad Company, dated December 29, 1904, recorded in the Lewis County Clerk's office on March 24, 1905, in Book 108 of Deeds at page 460.

23. Charles H. Steinhilber, Emma C. Steinhilber (his wife), and Jacob Steinhilber to the Lowville and Beaver River Railroad Company, dated December 26, 1904, recorded in the Lewis County Clerk's office on March 24, 1905, in Book 108 of Deeds at page 462.

24. John Bintz and Mary A. Bintz (his wife) to the Lowville and Beaver River Railroad Company, dated December 24, 1904, recorded in the Lewis County Clerk's office on March 24, 1904, in Book 108 of Deeds at page 463.

25. Corneluis Heimhelger and Lydia Heimhelger (his wife) to the Lowville and Beaver River Railroad Company, dated December 30, 1904, recorded in the Lewis County Clerk's office on March 24, 1905, in Book 108 of Deeds at page 464.

26. Jennie E. Garnsey to the Lowville and Beaver River Railroad Company, dated December 31, 1904, recorded in the Lewis County Clerk's office on March 24, 1905, in Book 108 of Deeds at page 466.

27. Fred Sauer and Emma W. Sauer (his wife) to the Lowville and Beaver River Railroad Company, dated December 31, 1904, recorded in the Lewis County Clerk's office on March 24, 1905, in Book 108 of Deeds at page 467.

28. Andrew Martin and Barbara Martin (his wife) to the Lowville and Beaver River Railroad Company, dated January 2, 1905, recorded in the Lewis County Clerk's office on March 24, 1905, in Book 108 of Deeds at page 468.

29. Jesse J. Kellogg and Minnie G. Kellogg (his wife) and K. Collins Kellogg to the Lowville and Beaver River Railroad Company, dated January 11, 1905, recorded in the Lewis County Clerk's office on March 24, 1905, in Book 108 of Deeds at page 469.

30. Luke Tunney and Catherine Tunney (his wife) to the Lowville and Beaver River Railroad Company, dated January 6, 1905, recorded in the Lewis County Clerk's office on March 24, 1905, in Book 108 of Deeds at page 470.

31. Nathaniel S. Virkler and Anna M. Virkler (his wife) to the Lowville and Beaver River Railroad Company, dated January 6, 1905, recorded in the Lewis County Clerk's office on March 24, 1905, in Book 108 of Deeds at page 471.

32. Sarah A. Burkhard to the Lowville and Beaver River Railroad Company, dated February 8, 1905, recorded in the Lewis County Clerk's office on March 24, 1905, in Book 108 of Deeds at page 472.

33. Hannah Austin to the Lowville and Beaver River Railroad Company, dated February 8, 1905, recorded in the Lewis County Clerk's office on March 24, 1905, in Book 108 of Deeds at page 473.

34. Anthony Miller and Mary Miller (his wife) to the Lowville and Beaver River Railroad Company, dated February 8, 1905, recorded in the Lewis County Clerk's office on March 24, 1905, in Book 108 of Deeds at page 475.

35. Fredrick A. Garnsey to the Lowville and Beaver River Railroad Company, dated February 8, 1905, recorded in the Lewis County Clerk's office on March 24, 1905, in Book 108 of Deeds at page 476.

36. Phillips Artz and Catherine Artz (his wife) to the Lowville and Beaver River Railroad Company, dated May 10, 1905, recorded in the Lewis County Clerk's office on May 15, 1905, in Book 108 of Deeds at page 583.

37. James H. Boshart and Clara A. Boshart (his wife) to the Lowville and Beaver River Railroad Company, dated May 3, 1905, recorded in the Lewis County Clerk's office on May 15, 1905, in Book 108 of Deeds at page 585.

38. Ora P. Lomber to the Lowville and Beaver River Railroad Company, dated April 20, 1905, recorded in the Lewis County Clerk's office on May 15, 1905, in Book 108 of Deeds at page 586.

39. John W. Johnson to the Lowville and Beaver River Railroad Company, dated March 18, 1905, recorded in the Lewis County Clerk's office on March 29, 1905, in Book 109 of Deeds at page 65.

40. Joseph J. Virkler and Anna M. Virkler, his wife, to the Lowville and Beaver River Railroad Company, dated March 6, 1905, recorded in the Lewis County Clerk's office on March 29, 1905, in Book 109 of Deeds at page 66.

41. Benjamin T. Farney and Martha Farney, his wife, to the Lowville and Beaver River Railroad Company, dated March 28, 1905, recorded in the Lewis County Clerk's office on March 29, 1905, in Book 109 of Deeds at page 67.

42. Lucinda E. Richner to the Lowville and Beaver River Railroad Company, dated March 27, 1905, recorded in the Lewis County Clerk's office on March 29, 1905, in Book 109 of Deeds at page 68.

43. Edward Casler and Minnie Casler (his wife) to the Lowville and Beaver River Railroad Company, dated March 30, 1905, recorded in the Lewis County Clerk's office on March 31, 1905, in Book 109 of Deeds at page 70.

44. Noel E. Jones and Ann E. Jones, his wife, to the Lowville and Beaver River Railroad Company, dated May 3, 1905, recorded in the Lewis County Clerk's office on July 11, 1905, in Book 109 of Deeds at page 170.

45. The Asbestos Burial Casket Company to the Lowville and Beaver River Railroad Company, dated July 10, 1905, recorded in the Lewis County Clerk's office on July 11, 1905, in Book 109 of Deeds at page 171.

46. Anna Smith to the Lowville and Beaver River Railroad Company, dated July 14, 1905, recorded in the Lewis County Clerk's office on July 15, 1905, in Book 109 of Deeds at page 175.

47. Edward O'Brien and Mary O'Brien, his wife, to the Lowville and Beaver River Railroad Company, dated August 16, 1905, recorded in the Lewis County Clerk's office on August 18, 1905, in Book 109 of Deeds at page 197.

48. James H. Kearus to the Lowville and Beaver River Railroad Company, dated November 9, 1904, recorded in the Lewis County Clerk's office on August 18, 1905, in Book 109 of Deeds at page 198.

49. Theo B. Basselin and Florence Basselin, his wife, to the Lowville and Beaver River Railroad Company, dated May 30, 1905, recorded in the Lewis County Clerk's office on May 31, 1905, in Book 110 of Deeds at page 38.

50. Dewitt C. West (unmarried) to the Lowville and Beaver River Railroad Company, dated May 25, 1905, recorded in the Lewis County Clerk's office on June 3, 1905, in Book 110 of Deeds at page 55.

51. Joseph Herman and Josephine Herman (his wife) to the Lowville and Beaver River Railroad Company, dated May 19, 1905, recorded in the Lewis County Clerk's office on June 3, 1905, in Book 110 of Deeds at page 57.

52. Michael Virkler and Mary Virkler (his wife) to the Lowville and Beaver River Railroad Company, dated June 22, 1905, recorded in the Lewis County Clerk's office on June 26, 1905, in Book 110 of Deeds at page 136.

53. Samuel G. Virkler and Magdalena Virkler, his wife, to the Lowville and Beaver River Railroad Company, dated July 7, 1905, recorded in the Lewis County Clerk's office on July 11, 1905, in Book 110 of Deeds at page 213.

54. Charles E. Boshart and Julia V. Boshart (his wife) to the Lowville and Beaver River Railroad Company, dated August 3, 1905, recorded in the Lewis County Clerk's office on August 14, 1905, in Book 110 of Deeds at page 253.
55. Charles E. Boshart and Julia V. Boshart, his wife, to the Lowville and Beaver River Railroad Company, dated August 3, 1905, recorded in the Lewis County Clerk's office on August 4, 1905, in Book 110 of Deeds at page 254.
56. Adelbert M. Searls and Anna Searls (his wife) to the Lowville and Beaver River Railroad Company, dated August 4, 1905, recorded in the Lewis County Clerk's office on August 7, 1905, in Book 110 of Deeds at page 261.
57. Adelbert M. Searls and Charles E. Searls, Anna Searls and Florence K. Searls to the Lowville and Beaver River Railroad Company, dated August 4, 1905, recorded in the Lewis County Clerk's office on August 7, 1905, in Book 110 of Deeds at page 262.
58. James W. Lomber and Anna Lomber (his wife) to the Lowville and Beaver River Railroad Company, dated August 7, 1905, recorded in the Lewis County Clerk's office on August 11, 1905, in Book 110 of Deeds at page 270.
59. Lillian Cutler to the Lowville and Beaver River Railroad Company, dated January 31, 1906, recorded in the Lewis County Clerk's office on February 1, 1906, in Book 111 of Deeds at page 211.
60. Joseph E. Ebersoll and Catherine Ebersoll (his wife) to the Lowville and Beaver River Railroad Company, dated August 2, 1906, recorded in the Lewis County Clerk's office on August 3, 1906, in Book 112 of Deeds at page 106.
61. Warren R. Fitch to the Lowville and Beaver River Railroad Company, dated August 1, 1906, recorded in the Lewis County Clerk's office on August 6, 1906, in Book 112 of Deeds at page 110.

62. Sarah E. Abell an Emma Ruth Abell to the Lowville and Beaver River Railroad Company, dated April 11, 1906, recorded in the Lewis County Clerk's office on November 15, 1906, in Book 112 of Deeds at page 493.

63. Anna Marguerita Abell and Leon E. Abell to the Lowville and Beaver River Railroad Company, dated October 29, 1906, recorded in the Lewis County Clerk's office on November 15, 1906, in Book 112 of Deeds at page 495.

64. Anna Marguerita Abell and Leon E. Abell, infants over the age of fourteen years, by Henry C. Abell, Special Guardian, and the infant children of Sarah C. Abell not yet in being to the Lowville and Beaver River Railroad Company, dated April 12, 1906, recorded in the Lewis County Clerk's office on November 15, 1906, in Book 112 of Deeds at page 496.

65. Christopher Largett and Barbara Largett (his wife) to the Lowville and Beaver River Railroad Company, dated May 6, 1907, recorded in the Lewis County Clerk's office on May 7, 1907, in Book 113 of Deeds at page 352.

66. George Largett and Susan Largett (his wife) to the Lowville and Beaver River Railroad Company, dated November 12, 1907, recorded in the Lewis County Clerk's office on November 13, 1907, in Book 114 of Deeds at page 100.

67. Margaret Hogan (widow), Thomas M. Hogan, John Hogan, Edward L. Hogan, Robert E. Hogan, Augusta Hogan (his wife), children and only heirs at law of Thomas Hogan, deceased, to the Lowville and Beaver River Railroad Company, dated February 14, 1907, recorded in the Lewis County Clerk's office on February 29, 1908, in Book 114 of Deeds at page 290.

68. Charles S. Mereness, Jr., Referee, to the Lowville and Beaver River Railroad Company, dated May 15, 1908, recorded in the Lewis County Clerk's office on May 15, 1908, in Book 114 of Deeds at page 443.



69. Gilbert A. Blackmon and Nellie M. E. Blackmon, his wife, to the Lowville and Beaver River Railroad Company, dated March 2, 1907, recorded in the Lewis County Clerk's office on June 15, 1908, in Book 114 of Deeds at page 492.

70. Yale Rice and Helen M. Rice, his wife, to the Lowville and Beaver River Railroad Company, dated February 8, 1909, recorded in the Lewis County Clerk's office on February 24, 1909, in Book 115 of Deeds at page 348.

71. Yale Rice and Helen M. Rice, his wife, to the Lowville and Beaver River Railroad Company, dated February 8, 1909, recorded in the Lewis County Clerk's office on February 24, 1909, in Book 115 of Deeds at page 349.

72. C. Fred Boshart and Clara S. Boshart, his wife, Edward J. Boshart and Helen S. Boshart, his wife, Nellie M. E. Blackmon, Grace B. Davenport and Margaret Boshart, as heirs at law and widow of Charles D. Boshart, deceased, to the Lowville and Beaver River Railroad Company, dated November 23, 1909, recorded in the Lewis County Clerk's office on November 30, 1909, in Book 116 of Deeds at page 297.

73. William M. Coates and the United Security Life Insurance and Trust Company of Pennsylvania, who survived Thomas Gillespie, Co Executors and Trustees of the last Will and testament of William Gillespie, late of the city of Philadelphia, deceased, to the Lowville and Beaver River Railroad Company, dated June 22, 1912, recorded in the Lewis County Clerk's office on June 26, 1912, in Book 119 of Deeds at page 240.

74. Joseph E. Ebersoll and Catherine Ebersoll (his wife) to the Lowville and Beaver River Railroad Company, dated January 6, 1913, recorded in the Lewis County Clerk's office on January 7, 1913, in Book 120 of Deeds at page 71.

75. Fulton Machine & Vice Company, William J. Milligan, as trustee, Northern New York Trust Company, as trustee, to the Lowville and Beaver River Railroad Company, dated January 5, 1917, recorded in the Lewis County Clerk's office on January 23, 1917, in Book 127 of Deeds at page 516.

76. Fred C. Pierce, Fred W. Coburn and Henry Purcell, as Executors of the Last Will and Testament of Theodore B. Basslin, late of Croghan Lewis County, N.Y., deceased, to the Lowville and Beaver River Railroad Company, dated April 12, 1917, recorded in the Lewis County Clerk's office on April 16, 1917, in Book 128 of Deeds at page 194.

77. Fred C. Pierce, Fred W. Coburn and Henry Purcell, as Executors of the last Will and Testament of Theodore B. Basslin, late of the Village of Croghan, Lewis County, N.Y., deceased, to the Lowville and Beaver River Railroad Company, dated April 2, 1917, recorded in the Lewis County Clerk's office on April 16, 1917, in Book 128 of Deeds at page 196.

78. The J. E. Haberer Furniture Company, to the Lowville and Beaver River Railroad Company, dated October 14, 1919, recorded in the Lewis County Clerk's office on October 15, 1919, in Book 133 of Deeds at page 497.

79. Gilbert A. Blackmon (unmarried) to the Lowville and Beaver River Railroad Company, dated October 23, 1923, recorded in the Lewis County Clerk's office on June 21, 1927, in Book 154 of Deeds at page 367.

80. The Asbestos Burial Casket Company, Inc. to the Lowville and Beaver River Railroad Company, dated March 4, 1924, recorded in the Lewis County Clerk's office on January 6, 1928, in Book 156 of Deeds at page 34.

81. Ella Bush (widow) to the Lowville and Beaver River Railroad Company, dated November 4, 1943, recorded in the Lewis County Clerk's office on August 27, 1945, in Book 200 of Deeds at page 109.

82. Agnes A. Virkler and Elmer Moser and Mable V. Moser, his wife, to the Lowville and Beaver River Railroad Company, dated May 1, 1947, recorded in the Lewis County Clerk's office on May 1, 1947, in Book 206 of Deeds at page 506.

83. Gilbert C. Blackmon and Retta K. Blackmon, his wife, and Fay L. Parker (unmarried) to the Lowville and Beaver River Railroad Company, dated November 9, 1948, recorded in the Lewis County Clerk's office on June 9, 1949, in Book 214 of Deeds at page 253.

84. Paul F. Ebersol and Gladys I. Ebersol to the Lowville and Beaver River Railroad Company, dated January \_\_, 1975, recorded in the Lewis County Clerk's office on January 22, 1975, in Book 351 of Deeds at page 29.

85. The J. P. Lewis Company to the Lowville and Beaver River Railroad Company, dated February 3, 1977, recorded in the Lewis County Clerk's office on February 4, 1977, in Book 372 of Deeds at page 273.

86. The Lowville and Beaver River Railroad Company to Anna Smith, dated August 2, 1905, recorded in the Lewis County Clerk's office on August 8, 1905, in Book 110 of Deeds at page 269.

87. The Lowville and Beaver River Railroad Company to Lillian S. Cutler, dated August 2, 1904, recorded in the Lewis County Clerk's office on May 19, 1911, in Book 118 of Deeds at page 79.

88. The Lowville and Beaver River Railroad Company to Fred C. Pierce, Fred W. Coburn and Henry Purcell, as Executors of the last Will and Testament of Theodora Basselin, late of the Village of Croghan, Lewis County, N.Y., dated April 2, 1917, recorded in the Lewis County Clerk's office on April 16, 1917, in Book 128 of Deeds at page 197.

89. The Lowville and Beaver River Railroad Company to The J. E. Harberer Furniture Company, dated October 14, 1919, recorded in the Lewis County Clerk's office on October 20, 1919, in Book 133 of Deeds at page 530.

90. The Lowville and Beaver River Railroad Company to Joseph F. Eversol, dated October 28, 1918, recorded in the Lewis County Clerk's office on October 9, 1924, in Book 147 of Deeds at page 280.

91. The Lowville and Beaver River Railroad Company to Village of Lowville, dated August 9, 1937, recorded in the Lewis County Clerk's office on August 9, 1937, in Book 178 of Deeds at page 562.

92. The Lowville and Beaver River Railroad Company to Beaver Falls Water District, dated December 31, 1937, recorded in the Lewis County Clerk's office on May 8, 1939, in Book 183 of Deeds at page 297.

93. The Lowville and Beaver River Railroad Company to Theodore Virkler, dated January 7, 1950, recorded in the Lewis County Clerk's office on January 16, 1950, in Book 216 of Deeds at page 261.

94. The Lowville and Beaver River Railroad Company to General Telephone Company of Upstate New York, Inc., dated June 10, 1955, recorded in the Lewis County Clerk's office on August 12, 1955, in Book 233 of Deeds at page 520.

95. The Lowville and Beaver River Railroad Company to General Telephone Company of Upstate New York, Inc., dated June 10, 1955, recorded in the Lewis County Clerk's office on August 12, 1955, in Book 233 of Deeds at page 523.

96. The Lowville and Beaver River Railroad Company to Niagara Mohawk Power Corporation, dated July 11, 1955, recorded in the Lewis County Clerk's office on September 8, 1955, in Book 234 of Deeds at page 57.

97. The Lowville and Beaver River Railroad Company to Stuart L. Albertson and Louise M. Albertson, husband and wife, as tenants by the entirety, dated October 22, 1958, recorded in the Lewis County Clerk's office on October 23, 1958, in Book 251 of Deeds at page 451.

98. The Lowville and Beaver River Railroad Company to Stuart L. Albertson and Louise M. Albertson, husband and wife, as tenants by the entirety, dated July 3, 1959, recorded in the Lewis County Clerk's office on July 8, 1959, in Book 255 of Deeds at page 495.

99. The Lowville and Beaver River Railroad Company to Harold N. Devaines and Emma L. Devaines, husband and wife, dated October 2, 1959, recorded in the Lewis County Clerk's office on July 13, 1960, in Book 260 of Deeds at page 380.

100. New York State Department of Public Works, Bureau of Rights of Way and Claims to Lowville & Beaver River Railroad, Beaver Falls Water District, General Telephone Company of Upstate New York Inc., Niagara Mohawk Power Corporation, dated October 5, 1960, recorded in the Lewis County Clerk's office on October 5, 1960, in Book 262 of Deeds at page 12.

101. New York State Department of Public Works, Bureau of Rights of Way and Claims to The Lowville and Beaver River Railroad Company, the Village of Lowville, Lowville Milk and Cream Co., dated March 23, 1967, recorded in the Lewis County Clerk's office on March 23, 1967, in Book 295 of Deeds at page 145.

102. The Lowville and Beaver River Railroad Company to General Telephone Company of Upstate New York, Inc., dated March 3, 1973, recorded in the Lewis County Clerk's office on June 7, 1973, in Book 332 of Deeds at page 274.

103. The Lowville and Beaver River Railroad Company to Francis A. Duflo, dated October 28, 1973, recorded in the Lewis County Clerk's office on November 29, 1973, in Book 339 of Deeds at page 57.

104. The Lowville and Beaver River Railroad Company to Paul F. Ebersol and Gladys I. Ebersol, his wife, dated January 22, 1975, recorded in the Lewis County Clerk's office on January 22, 1975, in Book 351 of Deeds at page 31.

105. The Lowville and Beaver River Railroad Company to Beaver River Health Services Council, Inc., dated January 22, 1975, recorded in the Lewis County Clerk's office on January 22, 1975, in Book 351 of Deeds at page 33.

106. The Lowville and Beaver River Railroad Company to James J. Scanlon, Margaret C. Scanlon and James E. Scanlon, joint tenants with right of survivorship, dated October 22, 1984, recorded in the Lewis County Clerk's office on August 15, 1985, in Book 459 of Deeds at page 185.

107. The Lowville and Beaver River Railroad Company to Brian N. Gravelly and Rosemary Miller Gravelly, husband and wife, as tenants by the entirety, dated October 27, 1987, recorded in the Lewis County Clerk's office on November 10, 1987, in Book 487 of Deeds at page 333.